

STERIS drawings do not supersede the drawings from the architect of record.

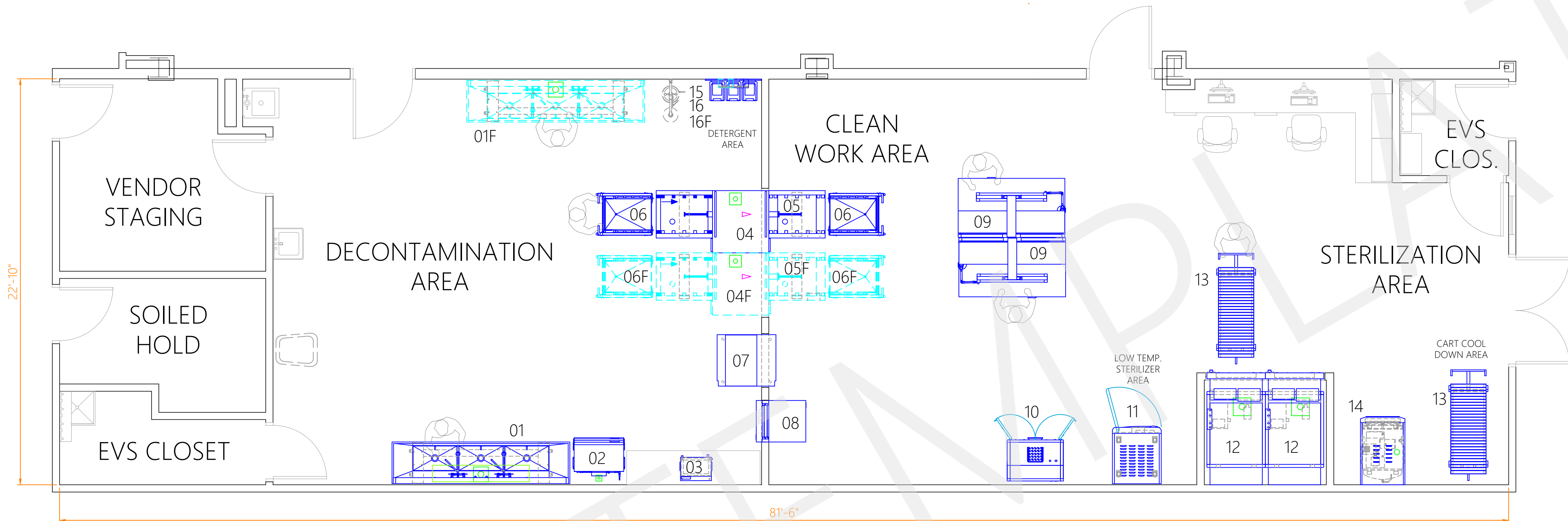

EQUIPMENT LIST		
TAG	QTY	DESCRIPTION
01	1	Amsco 50 Reprocessing Sink - 3 Bay/120" Long/Height Adjustable (Delivery may be restricted by hallway width. STERIS installation and delivery teams to verify prior to shipping.)
01F	1	Future Amsco 50 Reprocessing Sink - 3 Bay/120" Long/Height Adjustable (Delivery may be restricted by hallway width. STERIS installation and delivery teams to verify prior to shipping.)
02	1	InnoWave Unity Ultrasonic Irrigator - 15 Gallon
03	1	InnoWave ECO Ultrasonic Cleaner - Table Top/5.2 Gallon
04	1	Amsco 7053HP Single-Chamber Washer/Disinfector - Double Door/Electric Heat/Non-Vented/Flush Mounted
04F	1	Future Amsco 7053HP Single-Chamber Washer/Disinfector - Double Door/Electric Heat/Non-Vented/Flush Mounted
05	1	SCS-L Load/Unload Conveyor System - Single Load/Single Unload
05F	1	Future SCS-L Load/Unload Conveyor System - Single Load/Single Unload
06	2	Reliance Long Chamber Transfer Cart with Auto-Docking
06F	2	Future Reliance Long Chamber Transfer Cart with Auto-Docking
07	1	Amsco Rack Return - Offset Mounted
08	1	STERIS Automated Pass-Through Window - Endoscopy Application (28x45" Window)
09	2	Amsco Deluxe Prep and Pack Workstation - 36x72"/Electric Height Adjustable
10	1	Amsco Drying Cabinet - 38"/Single Door (110-120 Volt/20 Amp Dedicated Wall Plug)
11	1	Amsco V-PRO Max 2 Low Temperature Sterilization System - Single Door/Cabinet/Set of (4) Locking Casters (10 ft. power cord included)
12	2	Amsco 600 Medium Steam Sterilizer - 26.5x26.5x63" (673x673x1600mm)/Single Sliding Door/Recessed/Electric Heat
13	2	Amsco 600 Loading Car and Transfer Carriage - 26.5x26.5x63"/Fixed Height
14	1	Amsco 400 Small Steam Sterilizer - 20x20x38" (508x508x965mm)(250L)/Single Door/Cabinet/Electric Heat
15	1	Acu-Hold System - Wall Mounted/3 Container
16	1	STERIS Dosing System - 3 Pumps (Included with Washer/Power supplied by Washer)
16F	1	Future STERIS Dosing System - 3 Pumps (Included with Washer/Power supplied by Washer)

SQUARE FOOTAGE	
DECONTAMINATION AREA	630 SQFT
CLEAN WORK AREA	550 SQFT
STERILIZATION AREA	375 SQFT
VENDOR STAGING	120 SQFT
SOILED HOLD	80 SQFT
EVS CLOSET	50 SQFT

STERIS drawings do not supersede the drawings from the architect of record.

TEMPLATE NOTE: THIS LAYOUT IS INTENDED TO ENCOURAGE DISCUSSIONS FOR AN INTEGRATED DESIGN PROCESS. FOR A COMPREHENSIVE CAPACITY ASSESSMENT AND OPTIMIZED DESIGN FOR YOUR PROCESSING DEPARTMENT, PLEASE CONTACT YOUR LOCAL STERIS REPRESENTATIVE